



SHP1-HD

HEAVY DUTY STAINLESS STEEL COMMERCIAL STOCK POT BURNER

FEATURES:

- Heavy duty cast iron burners and cooking grate
- Stainless steel front plate
- Dual knobs control outside and inside burners
- Removable full width drip pan tray
- Chromed control knobs
- Durable stainless steel pilot ignitors
- Low profile height
- Natural gas or propane (propane conversion required)
- Wide and deep burner accommodates large pot sizes
- 4" stainless steel legs with 1" adjustable bullet feet

SPECIFICATIONS: SHP1-HD

Dimensions	18"W x 24"D x 22"H (incl. 4" legs)
Burners	3 Ring
Shipping Weight	145 lbs
Power	3/4 NPT Connection
BTU	80,000

* In the pursuit of a better product, durability and performance. SATURN reserves the right to change specifications, materials and design without further notice.

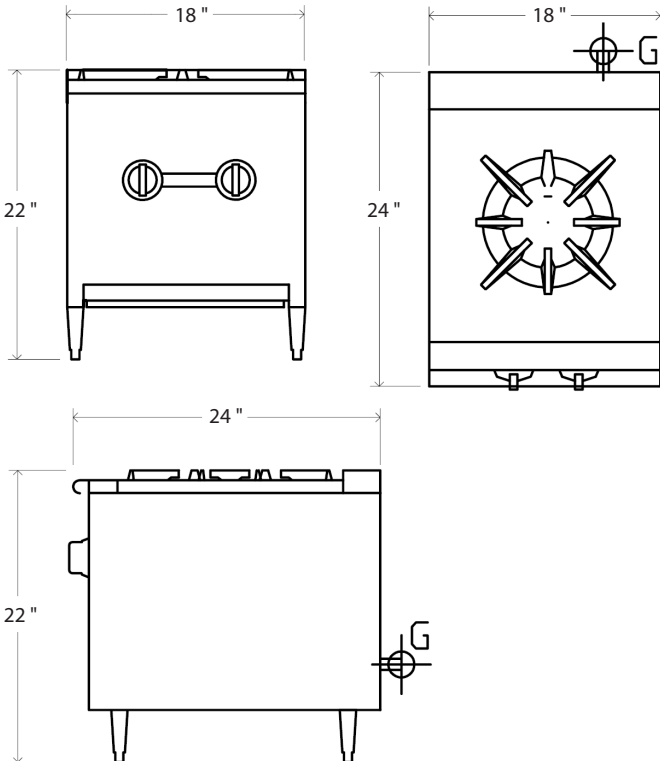

WARRANTY:
1 year parts and labor.